

Murraya 20



EMERGE

House Area

180.69 m²

Min Lot Size (WxL)

10.5m x 28m

As the largest in the Murraya collection, the Murraya 20 is a stunning 4-bedroom, 2-bathroom home with a 1-car garage designed for a 10.5m+ block. The heart of this single-storey home is the expansive rear living area, featuring a modern kitchen and family space that opens to an alfresco, ideal for entertaining. Optional upgrades like a butler's pantry and a second living area offer customisation to suit your lifestyle. The front of the home is graced with a luxurious master suite, complete with an ensuite and walk-in robe. The additional three bedrooms and a central bathroom and laundry are strategically located off the main passageway, ensuring both privacy and accessibility.

10.5M+ LOT WIDTH

SINGLE STOREY

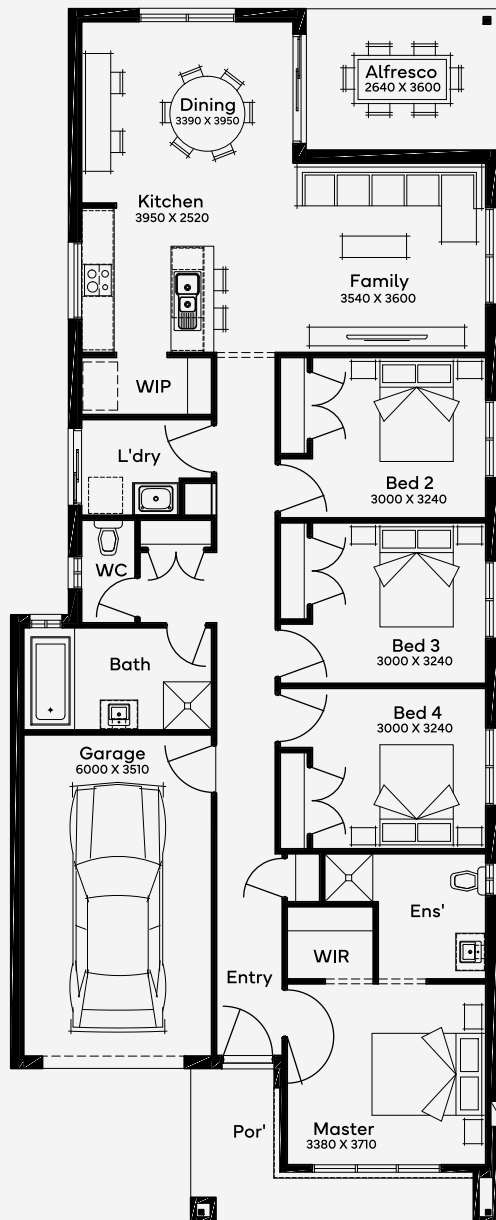

Please note: Some floorplan option combinations may not be possible together. Please speak to a New Home Specialist.
Base price shown as of 24 April 2026 and is subject to change.

