

Granite 23



Granite 23, a 4-bedroom, 2-bathroom home with 2 living spaces, is designed for a 12.5m+ block, embracing the essence of contemporary family life. The single-storey design features a spacious kitchen overlooking the dining area that leads to a welcoming alfresco, ideal for relaxed gatherings. The home prioritizes family comfort with a modern living zone perfect for movie nights. Three well-sized children's bedrooms are centrally located, while the separate master suite ensures tranquility. A classic lounge adds a touch of elegance and versatility.

EMERGE

House Area

220.52 m²

Min Lot Size (WxL)

12.5m x 30m

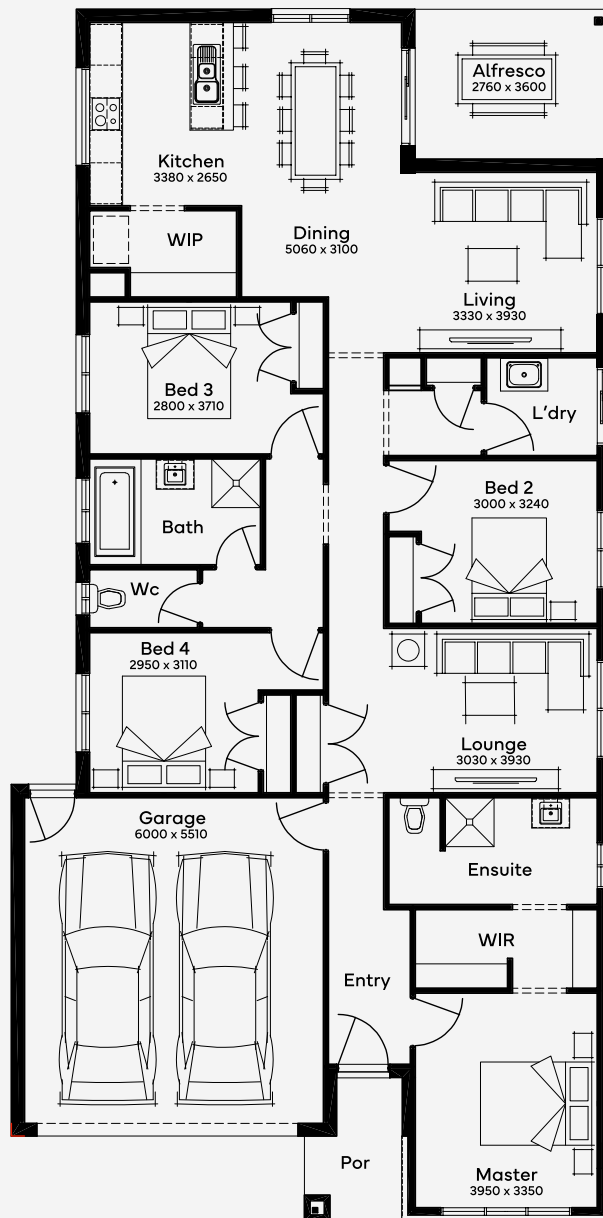

12.5M+ LOT WIDTH

SINGLE STOREY

Please note: Some floorplan option combinations may not be possible together. Please speak to a New Home Specialist.
Base price shown as of 24 April 2026 and is subject to change.

